



Catalogue
LAUNDRY
Chapter
WASHING

Model

LN-11 TP2 E 400/230/230V 3N/3/1N 50/60Hz

18001875

12/05/2020

NORMAL SPIN WASHER EXTRACTOR, LN-11 TP2 E

- Unit exterior manufactured in skin plate, colour grey, stainless steel appearance. Easy to clean and anti fingerprint.
- Drum and jacket in AISI-304 stainless steel.
- 8 automatic liquid dosing signals, with programmable time and delay. 6 extra signals available optionally.
- 3 standard water inlets.
- Variable-frequency drive (standard 50-60 Hz). Balancing system controlled by the same drive.
- New second-generation TOUCH PLUS programmer with 7" touch screen, 37 available languages and which lets you create an indefinite number of programs (29 pre-set), even play videos.
- Traceability as standard: the whole wash process (temperatures, water levels) is stored on the washer and is extractable to a PC by USB memory.
- Allows programming, importing and exporting of programs and software updates via USB.
- WET CLEANING characteristics included in the scheduler (modifiable water levels and washing speed).
- EFFICIENT MIX. These machines are equipped with an automatic water mixer (mixing different water temperatures) which provides energy savings and reduces washing times.
- BALANCE CONTROL. The washers detect the imbalance at an early stage. This way the operation is much smoother, elongating components lifetime and reducing washing times, thus saving energy as well.
- MULTICHOICE INLET. All washers are equipped with a third water inlet as standard, which allows you to save filling time, or which can be used for decalcified water, ozone or recycled water.
- MAINTENANCE KARE. A simple and reliable design with easy-to-access mechanical parts.
- OPTIMIZED DRUM. The effective design of the drum and tank allows the energy consumption necessary to heat the water, as well as the superfluous use of chemical products, to be reduced.
- OPTIMAL CONSUMPTION: Efficient system by means of which you can indicate the load which is introduced in the machine. The washer automatically adapts the quantity of water and chemicals to be used for that load.
- LOADING AID system. Water inlet and spin control for loading the linen.
- CE, WRAS and EAC product certifications.
- Optional ETL-certified version of the machine.
- Tank with 4 detergent compartments.
- The standard model can be converted to self-service by installing a pay station kit, coin mechanism kit or other payment system. RS-485 communication.
- Washers compatible with water recovery tanks.
- Maximum water consumption calculated in Programme nr. 20, 75% of loading.

ANCHORAGE TO THE FLOOR

- These machines need to be anchored to the floor.
- FAGOR offers anchoring bases specific to each model, which must be ordered separately.

OPTIONS:

- Reversible door.
- Automatic unblockage of the door.
- Tropicalised programmer.
- Printer

DIMENSIONS



X Width	719 mm	X Gross width	800 mm
Y Depth	684 mm	Y Gross depth	850 mm
Z Height	1158 mm	Z Gross height	1350 mm
Net Weight	217,0 kg	Gross Weight	225,0 kg
Net volume	0,570 m3	Gross volume	0,918 m3

ELECTRICITY TECHNICAL SPECIFICATIONS

Engine power	1,10 kW
Electric power	6,300 kW
Amperage (A)	10,1/16,5/27,5
Heating power	6,00 kW
Voltage	400/230/230V - 3N/3/1N
Electric frequency	50/60Hz

WATER TECHNICAL SPECIFICATIONS

Pressure	H2O: 200-400kPa(2-4bar)
Water max consumption	59,80 L/h

CONNECTIONS TECHNICAL SPECIFICATIONS

230 V three-phase wiring	3X2,5+T 20A
Single-phase 230V wiring	2X4+T 32A
Three-phase +N 400V wiring	4X1,5+T 16A
Water inlet diameter	3/4"
Drain 1 diameter	3"
Drainage capacity	200 l/min

OTHERS

Load capacity 1/9	11,00 kg
Load capacity 1/10	10,00 kg
Drum volume	100 L
Drum diameter	620 mm
Drum depth	330 mm
Wash speed	50,0 r.p.m.
Max revolutions	762 r.p.m.
G Factor	200
Fuerza máxima transmitida (kN)	2,0 ±3
Frequency of dynamic load (Hz)	8,93
Noise level	< 70,00 dB





Catalogue
LAUNDRY

Chapter
WASHING

Model
LN-11 TP2 E 400/230/230V 3N/3/1N 50/60Hz

18001875

12/05/2020

- Recirculation.
- SLUICE option.
- Silicone seal of the door.
- Extra dosage.
- Stainless steel unit.
- Stainless steel front.
- Drain normally closed.

Door position:

Height door centre: 570 mm

Height door base: 310 mm

"Working diameter of the door: 373 mm

"



Catalogue
LAUNDRY

Chapter
WASHING

Model
LN-11 TP2 E 400/230/230V 3N/3/1N 50/60Hz

18001875

12/05/2020

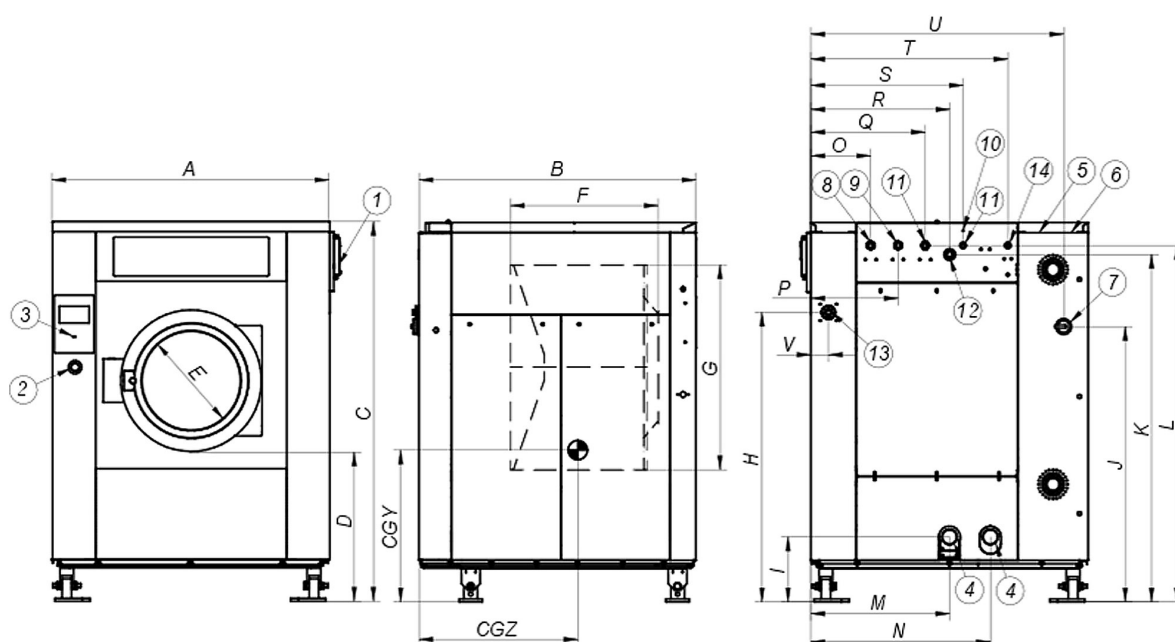

	A	B	C	D	E	F	G	H	I	J	K	L	M	N	O	P	Q	R	S	T	U	V	W	X	Y	CGY	CGZ
LN-11 TP2	719	684	1.158	310	373	144	440	886	1.054	889	1.073	958	61	74	101	316	376	637	475	211	654	607	1.073	424	1.118	383	511
LN-14 TP2	719	830	1.158	310	373	144	440	886	1.054	889	1.073	958	61	74	101	316	376	637	475	211	654	607	1.073	424	1.118	484	524
LN-18 TP2	788	840	1.307	348	460	108	552	1.035	1.203	1.038	1.222	1.107	61	74	101	385	445	706	544	249	724	676	1.203	485	1.202	479	546

- | | |
|--|--|
| 01. Jabonera | 01. Detergent box |
| 02. STOP paro de emergencia | 02. STOP Emergency button |
| 03. Puerto USB | 03. USB port |
| 04. desagüe | 04. Drain |
| 05. Conexión eléctrica a bombas de jabón líquido | 05. Electrical connection for soap dispenser |
| 06. Conexión eléctrica | 06. Electrical inlet |
| 07. Interruptor general | 07. Main switch |
| 08. Entrada de agua auxiliar | 08. Auxiliary water inlet |
| 09. Entrada de agua caliente | 09. Hot water inlet |
| 10. Toma de tierra | 10. Ground connection |
| 11. Entrada de agua fría | 11. Cold water inlet |
| 12. Rebosadero de agua | 12. Overflow |
| 13. Conexión para jabón líquido | 13. Connection for liquid soap |
| 14. Conexión de vapor | 14. Steam inlet |